

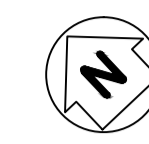

GADHINGLAJ INDUSTRIAL AREA



NORTH DIRECTION

GADHINGLAJ INDUSTRIAL AREA

AREA STATEMENT

AS ON 24.6.2016

|  |                    |
|--|--------------------|
| NOTIFIED AREA                                      | 135.32 H.          |
| A) Total area in possession                        | 132.52 H.          |
| B) Deduction                                       |                    |
| 1) Area under large size plots more than 4.0 Hect. | 101.0 H.           |
| 2) Area unsuitable for plots                       |                    |
| 3) Area under Highest Flood Level                  | 0.2265 H.          |
| 4) Area under Pipeline                             | 0.2092 H.          |
|  | 0.0389 H.          |
|  | 0.0919 H.          |
| B) Net Deduction                                   | Total= 101.5665 H. |
| C) Net area for calculation (A-B)                  | 30.95 H.           |
| D) Open Space required 10% of (C)                  | 3.095 H.           |
| E) Open Space provided                             | 3.20 H.            |
| F) Amenity Space required 5% of (C)                | 1.547 H.           |
| G) Amenity Space provided                          | 10.39 H.           |

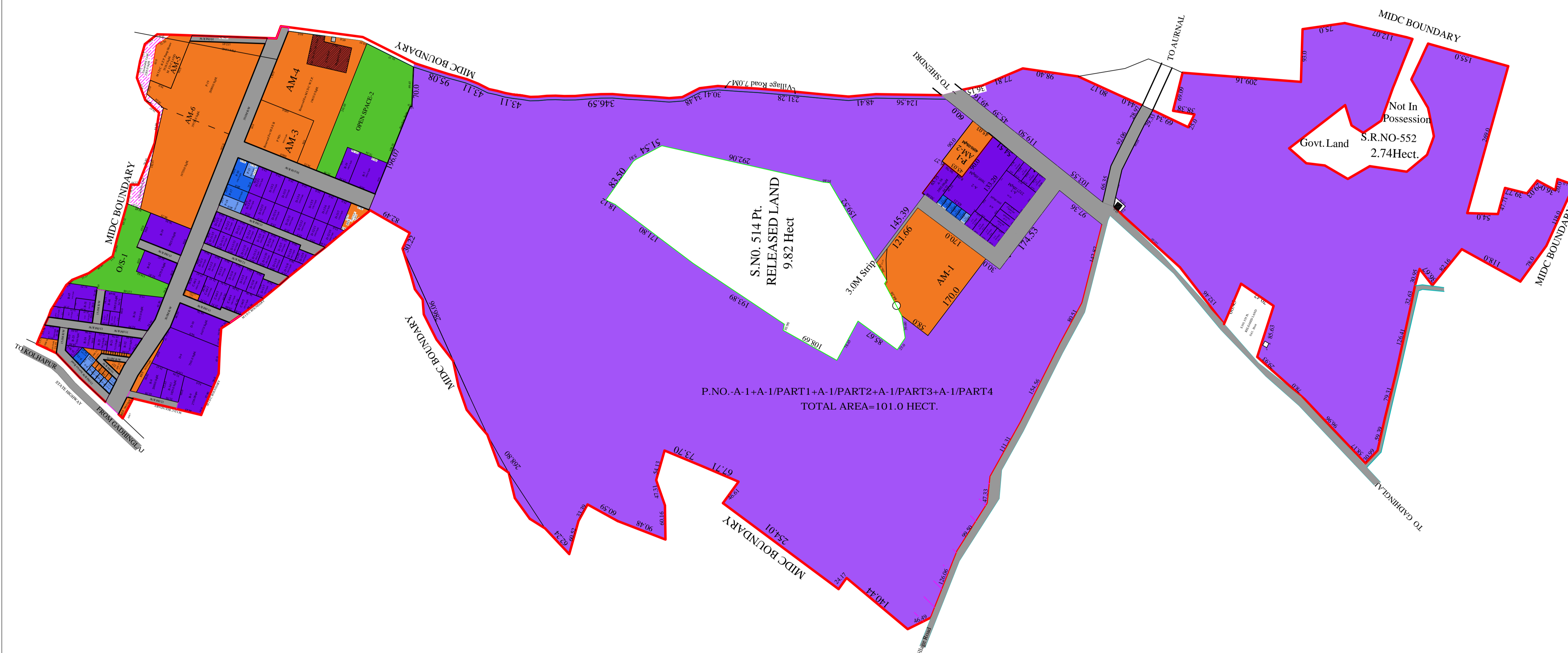

| LAND USE INDEX    |                           |                         |
|-------------------|---------------------------|-------------------------|
| LAND USE          | ALLOTTED PLOTS COLOR CODE | VACANT PLOTS COLOR CODE |
| RESIDENTIAL       |                           |                         |
| INDUSTRIAL        |                           |                         |
| PAP INDUSTRIAL    |                           |                         |
| COMMERCIAL        |                           |                         |
| PAP COMMERCIAL    |                           |                         |
| ROADS             |                           |                         |
| AMENITIES         |                           |                         |
| OPEN SPACE        |                           |                         |
| FOREST            |                           |                         |
| NALA              |                           |                         |
| ELECTRIC CORRIDOR |                           |                         |
| ENCROACHMENT      |                           |                         |
| DISPUTED LAND     |                           |                         |
| RELEASED LAND     |                           |                         |
| PL LAND           |                           |                         |

LIST OF PLOTS ABOVE 4.0 HECT.

|                         |           |
|-------------------------|-----------|
| AREA OF A1 PART 1&2&3&4 |           |
| TOTAL                   | 101 HECT. |

LIST OF PLOTS BELOW 4.0 HECT.

|         |         |       |          |        |         |            |                    |             |                     |
|---------|---------|-------|----------|--------|---------|------------|--------------------|-------------|---------------------|
| A-2     | 7695.00 | A-15  | 517.00   | B-27   | 555.00  | C-64/1     | 1000.00            | D-12/9      | 540.00              |
| A-3     | 500.00  | A-16  | 2002.00  | B-28   | 505.00  | C-64/2     | 1000.00            | D-12/10     | 888.00              |
| A-4     | 500.00  | A-1/4 | 25802.00 | B-30/4 | 293.00  | C-64/3     | 1000.00            | D-12/11TO16 | 6000.00 (1000 EACH) |
| A-5     | 500.00  | A-1/3 | 36013.00 | B-30/7 | 345.00  | C-64/4     | 1000.00            | D-13/1TO7   | 8750.00 (1250 EACH) |
| A-6     | 500.00  | B-7   | 2930.00  | B-30/9 | 431.00  | C-64/5     | 1071.00            |             |                     |
| A-7&A-8 | 500.00  | B-8   | 2000.00  | B-31   | 690.00  | D-9        | 7561.00            |             |                     |
| A-9     | 500.00  | B-9   | 2736.00  | B-32   | 850.00  | D-10       | 4147.00            |             |                     |
| A-10    | 500.00  | B-19  | 1485.00  | B-34/1 | 1629.00 | D-11/1TO6  | 4000.00 (800 EACH) |             |                     |
| A-11    | 500.00  | B-21  | 713.00   | B-34/2 | 2096.00 | D-11/7     | 715.00             |             |                     |
| A-12    | 500.00  | B-23  | 706.00   | B-38   | 3915.00 | D-11/8     | 885.00             |             |                     |
| A-13    | 500.00  | B-24  | 719.00   | B-39   | 3825.00 | D-11/9TO15 | 4200.00 (600 EACH) |             |                     |
| A-14    | 500.00  | B-25  | 738.00   | B-42   | 2475.00 | D-12/1TO8  | 4800.00 (600 EACH) |             |                     |
|         |         | B-26  | 590.00   | B-44   | 1065.00 |            |                    |             |                     |

AMENITY AREA SQ.MT

|         |            |
|---------|------------|
| AM-1    | 23325      |
| AM-2    | 4050       |
| AM-3    | 8000       |
| AM-4    | 19625      |
| AM-5    | 5518       |
| AM-6    | 39720      |
| AM-7    | 0.0        |
| AM-8    | 275        |
| AM-9    | 1100       |
| AM-10   | 620        |
| AM-11   | 348        |
| AM-12/A | 480        |
| AM-12/B | 390        |
| AM-13   | 435        |
| TOTAL   | 103876     |
|         | 10.39 HECT |

OPEN SPACE AREA SQ.MT

|       |           |
|-------|-----------|
| O/S-1 | 10651     |
| O/S-2 | 21332     |
| TOTAL | 31983     |
|       | 3.20 HECT |

MIDC ARCHITECTURE & TOWN PLANNING DEPT.

GADHIGLAJ INDL. AREA DIST. KOLHAPUR

APPROVED VIDE LETTER No. MIDC/CP/699 DT. 13-03-2008

|           |               |               |                |                  |
|-----------|---------------|---------------|----------------|------------------|
| SURVEYOR/ | HEAD SURVEYOR | ASST. PLANNER | DEPUTY PLANNER | REGIONAL OFFICER |
|-----------|---------------|---------------|----------------|------------------|

|                   |                     |                        |                     |
|-------------------|---------------------|------------------------|---------------------|
| ASST. PLANNER(HQ) | DEPUTY PLANNER (HQ) | ASSOCIATE PLANNER (HQ) | SENIOR TOWN PLANNER |
|-------------------|---------------------|------------------------|---------------------|

CHIEF PLANNER      DY.CEO (2)      JT.CEO